

INSTRUCTION FOR INSTALLATION

- Prepare a clean free table
 - Prepare 3 screw driver: plate 4mm, tork n.10, cross 5mm
- Bepatient: if in this operation the binding will be totally dismounted you can easily remount its parts.

1) Unscrew the back little plane screw, arrow in the full back position.

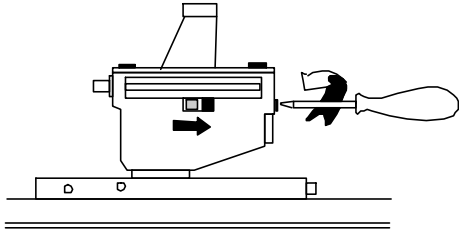

Use: plate screwdriver 4mm

2) Unscrew the 4 top screws. Take care to press the plate and not move the binding if you do this the binding is re-mounted else you must remount it..

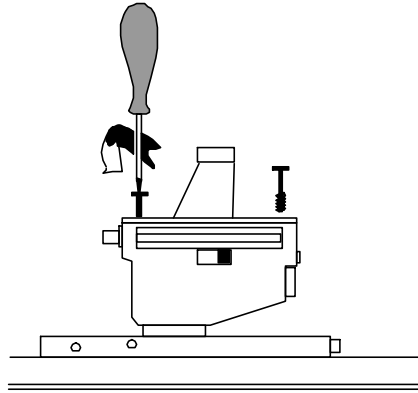

Use: TORQ n10 screwdriver

3) install the CLICK-CLACK insert the 4 screws in the hole and lock it DONOT OVERTURN THE SCREW!!!! Stop turn when the screw touches the base Overturn can destroy the binding.

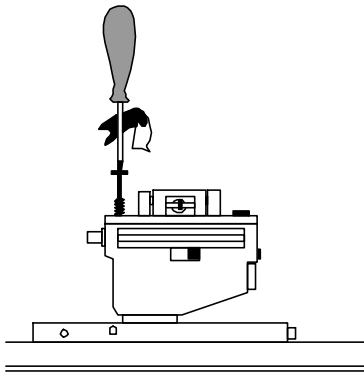

Use: TORQ n10 screwdriver

4.1) INSTALL THE INOX PLATE (1) Lock the 2 inox screws into the hole. Lock without overturn!

4.2) MAKE THE NEW SAFETY REGULATION on the back screw of the bindings. (2)

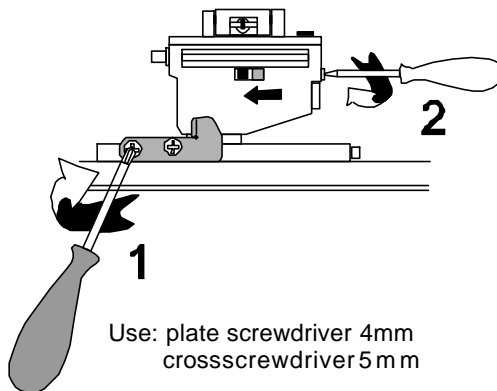

Use: plate screwdriver 4mm
cross screwdriver 5mm

CHECK POSITION OF THE BINDINGS:

- Check if the boots can free moves in climbing position.
- If the boot touch the binding please make this adjustment:
- Use the back bottom screw to arrange the position of the binding since it become free than turn the bindings in locked position (downhill) check if the pivot pass for 1-2mm the steel plate on the boot.



Right inox plate mounting position !



How to remove the SKI-STOPPER

- Prepare a clean free table
- Prepare a 5mm cross screw driver
- Unscrew the 4 cross screw of the skistopper

A) Unscrew the big back screw.

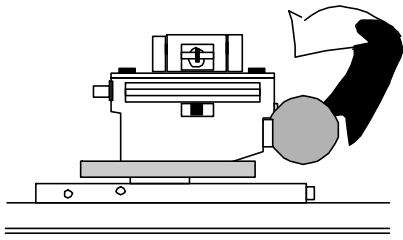

B) Pull-up the bindings and pull down the bottom plate.

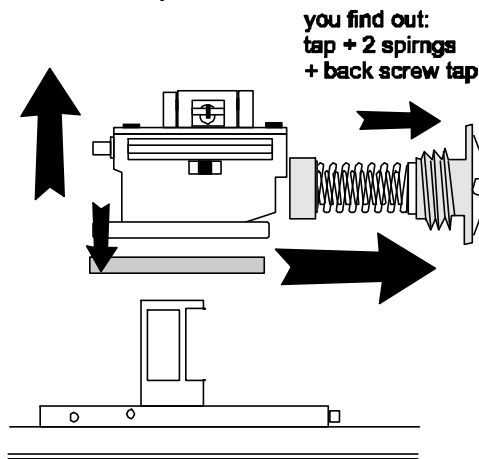

C1) RE INSERT THE BINDING (DISMOUNTED)

C2) REINSERT THE PLASTIC TAP THEN THE SPRING AND THE BACK SCREW TAP

C3) Screw the tap with the coi since therealese charge isthecorrectone.

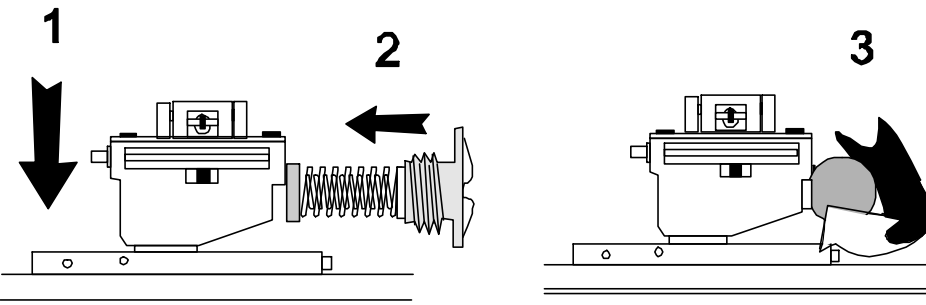

Click-Clack step for Dynafit TLT SPEED

HOW TO USE IT:

Click-Clack step is made in simple parts: a base and a movable lever driven by an inox spring. Mounting do not modify the safety release of the boot.

1.0 WHERE IT CAN BE INSTALLED

Click-Clack can be installed on all Dynafit bindings, but just on the Speed series can be used for hard slope:

- TLT SPEED series (arancioni, gialli o grigi) can be used with our stop to turning system: a little Inox plate that stop binding turn in case of crossing steep slope (that falls at your left). This problem is present on all Dynafit bindings when there is no trace on the ice slope.

- Titan RAC needs special add-on parts available from next fall 2006
- COMFORT series needs special add-on parts available from next fall 2006 and drilling work.

For the correct mounting please read and follow the attached instructions!

2.0 USE

THE USE IS VERY SIMPLE:

- Before start turn the binding in climbing free position (the only one you use now for climbing).
- When the slope becomes steep touch the lever with your stick

• To come back to a free position:

- . Make a step ahead (f.e. right ahead).
- . left foot back and up
- . turn left and with the LEFT stick point pull-up the lever..

2.1 - AT THE END OF THE DAY DRY THE BINDINGS!

L'Ergal and Inox are waterproof material, but the mix of salt and acid present in the snow can attack it. Wd40 is suggested as maintenance oil.

2.2 - WHEN USE THE LEVER DOWN:

The use is very easy, so use it every time you need!

Maximum step altitude can be used to turning two times the binding and living up the lever, but in this position your skin have no grip on the snow. Inevitably use it! Make two turns, is fast and easy!

2.3 - DAHU STEP:

Dahu is a mythical animal that lives all the time on the slope to turning in the same sense so it has 2 legs longer than the others... You can do the same step (especially in long slope crossing with an internal trace higher than the other) with the external (to the valley) lever down and the internal one up: your leg sticks you for this!

Since these devices are used in very hard conditions you accept that the use is at your own risk.